

- 1** Begin by cleaning the screen with the Wet Wipes and the Microfiber Cleaning Cloth.

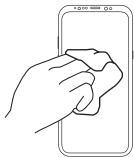

- 2** Remove any case from the phone. Place the Easy Installation Tray on the phone, aligning the top of the tray with the top of the phone.

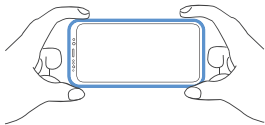

- 3** Peel off the mask film to expose the adhesive surface of the screen protector.



- 4** Using the Easy Installation Tray as an alignment guide, line up the top or bottom of the protector and carefully place the protector on the phone.

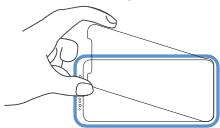

- 5** Using your index finger, swipe down the middle of the screen, making the protector begin to adhere to the phone. At this step, only the middle of the protector will be attached to the phone.

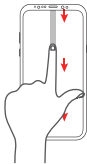

- 6** Remove the installation tray from the phone.

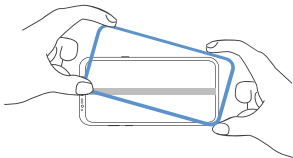

- 7** On the right-hand side of the phone, take the squeegee and FIRMLY push from bottom to top, pushing the air out of the TOP of the phone.

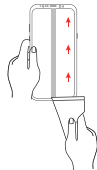

- 8** FIRMLY repeat on the left side of the phone, directing air to come out of the TOP of the phone.

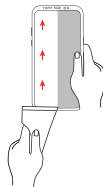

- 9** If there are any bubbles, lift the NEAREST corner to the bubble, and re-squeegee that area. Repeat until all bubbles are gone.

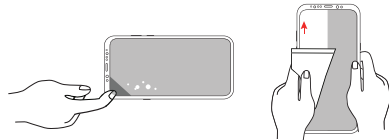

Damaged or Arrived Broken?

Try our 1-Click Warranty Claim

Go to TechMatte.com/WarrantyClaim

OR

Scan the QR Code Below.



Want More Coverage?

Unlock our Lifetime Warranty

Go to TechMatte.com/Register

OR



24/7 Customer Support



support@techmatte.com

www.techmatte.com

STAY CONNECTED



@TechMatte



@TechMatte



/TechMatte

amFilm®

Installation Guide

Scan Me



or visit

www.TechMatte.com/install/GLS04